



Richard A. Kiser  
2.3 acres

George J. Rahring  
Bishop of Toledo

John B. & Sarah Kurtz to Milan Cemetery Association  
March 26, 1927  
6.358 acres  
vol 131 page 471  
purchased by Galpin funds

36 acres  
Verna L. and Roy H. Williams to  
Milan Cemetery Association  
vol 92 page 336  
February 13, 1911

Special contributions  
Mowery 4/6/1998 income from \$13,160.38 maintenance  
preservation and repair of monuments and grave markers  
Lot # 489W, 490, 505 old section

Verna Williams  
Burt Newton  
Soyles  
Hastings

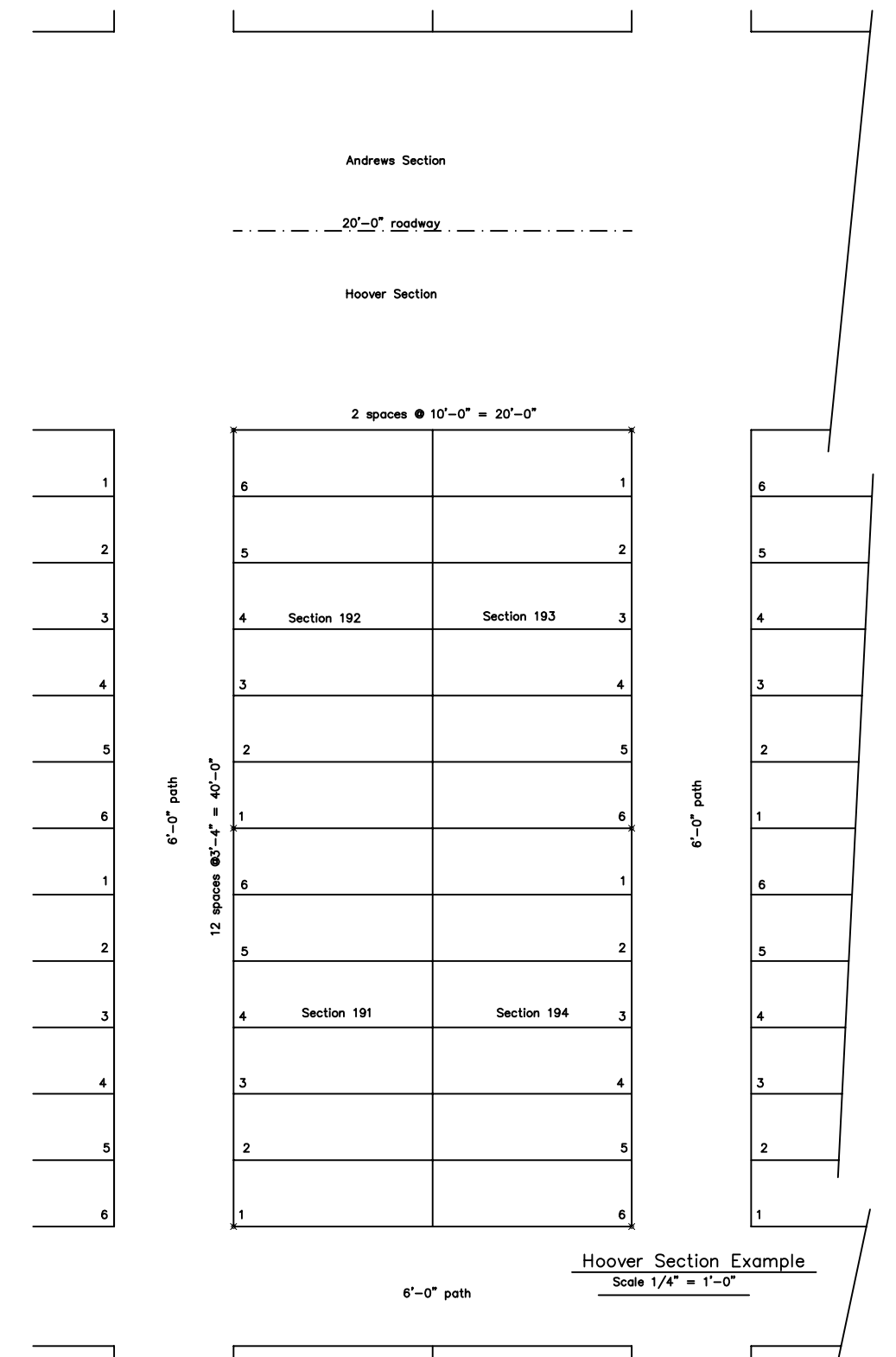

MILAN CEMETERY ASSOCIATION  
organized Jan 14, 1851

Andrews Annex to  
Milan Cemetery Association  
Vol 91 page 95  
3 acres  
March 22, 1910

Robert & Rebecca Fowler  
to Milan Cemetery Association  
Jan 25, 1888  
vol 51 page 429  
or Jerome Barber?

Gertrude A. & John A. Romell  
vol 122 page 541  
November 14, 1923  
July 3, 1924

Gertrude A. & John A. Romell  
vol 113 page 367  
March 27, 1920

Hastings Memorial Nov. 5, 1921  
vol 117 page 543

Huron Institute 1832 vol 7 page 231  
Western Reserve Normal School 1858  
to Milan Cemetery Association  
May 1917 vol 106 page 91  
to be used only as a public park and entrance to the cemetery

E.A. Frith  
Eliza J. Stoddard to  
William T. & Grace Croft  
to Jerome Barber  
to Milan Cemetery Association  
May 1917 vol 106 page 91  
aug 12, 1930

Val. Strickradt  
Amelia & Fonder Ackerman  
to Milan Cemetery Association  
vol 140 page 467  
October 7, 1929

Theo. R. & Anna Washburn to  
Fred & Mary Deninger to  
Milan Cemetery Association  
vol 83 page 258  
mar 23, 1910

Purchased with funds from William Galpin to be known as  
"Galpin Memorial Park" not to be used for burials,  
to be preserved in natural state.  
William A. Andrews, Elienna B. Andrews, Helen A. Mowery, Louis C. Mowery  
to Milan Cemetery Association  
vol 131 page 224  
25.88 acres  
Nov 8, 1925

